

Golden Goal 44 ELEMENT-PB

Official Size: 6.5'H x 12' W x 4' T x 6.5'B

4"x4" Square Ext. Alum. w/ .75 Radius Corners For Safety
 Reinforced Corners For Extra Durability
 Transport Wheels, Net & Rear Tie Downs Included
 Uprights, Crossbar & Backstay Powder Coated White

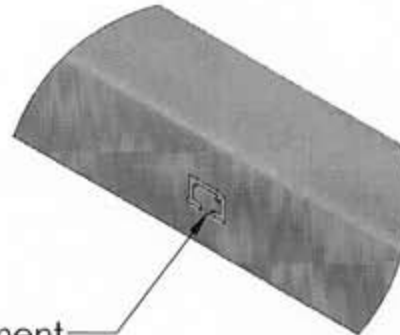

Exclusive "Stay-Put" Net Attachment

DETAIL A
 SCALE 20 : 105

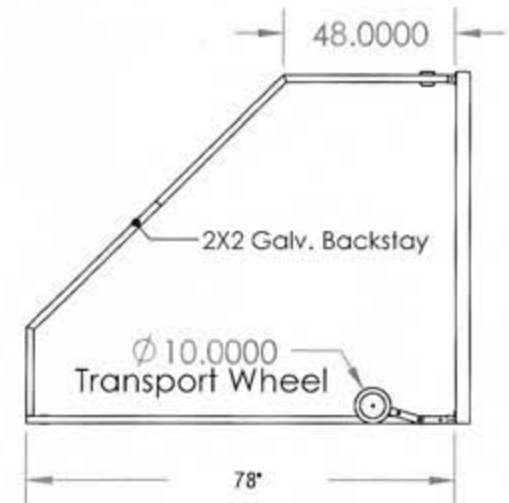
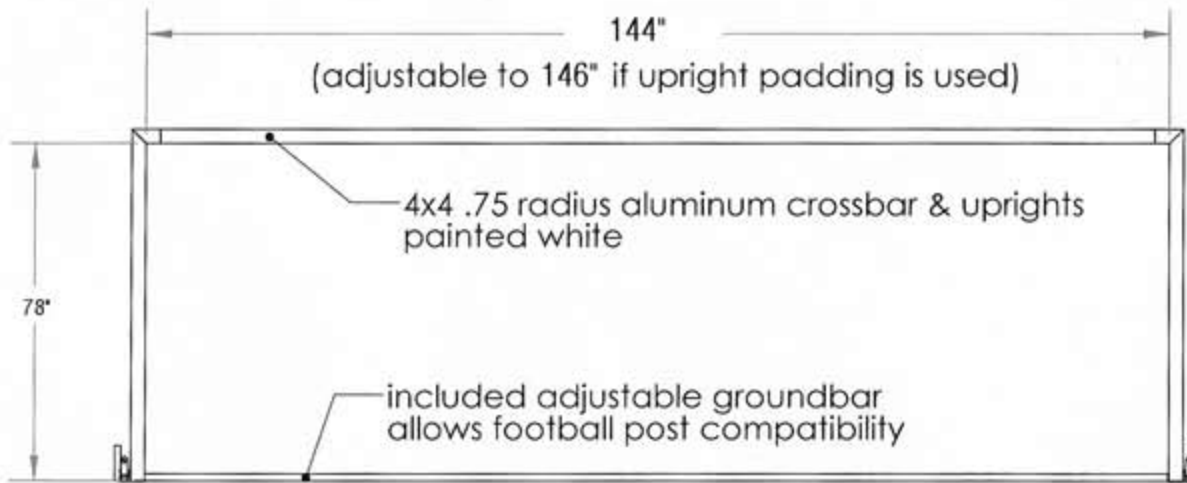
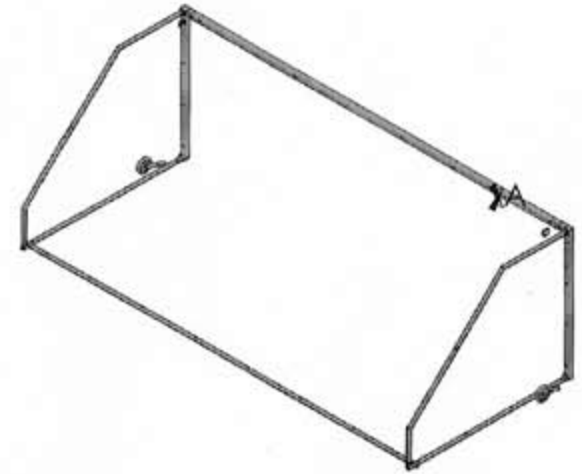

FIRST TEAM SPORTS INC.
 HUTCHINSON, KS 67501

First Team Dealer: Tom Nicotera
 Toll Free: 877-272-5430 / Cell: 858-692-1532
www.institutionalsportsequipment.com

	NAME	DATE	TITLE:		
DRAWN	JLR		First Team Sports, Inc.		
CHECKED					
ENG APPR.					
MFG APPR.					
Q.A.					
COMMENTS:			SIZE	DWG. NO.	REV
			A		
			SCALE: 1:55	WEIGHT	SHEET 1 OF 1